

Motor 4a - ESCAP 34L11 - 219E and 222E

E3-A. Drg 4a 9/85

DC permanent magnet motors manufactured by Portescap, Switzerland.

Ironless rotors with skew windings. 5 segment commutators with precious metal brushgear. 219E has sealed ball bearings. 222E has self-lubricating sintered bearings.

	219E	222E
Nominal voltage	24 volts	18 volts
No load speed	5400 rpm	5100 rpm
Stalled current	1.5 amps	2.0 amps
Maximum recommended continuous current	0.8 amps	1.0 amps
Stalled torque	1080 gm cm	1066 gm cm

Data source: Manufacturer's data sheets.

Available from B. McIntee, Stanmore, Middx.

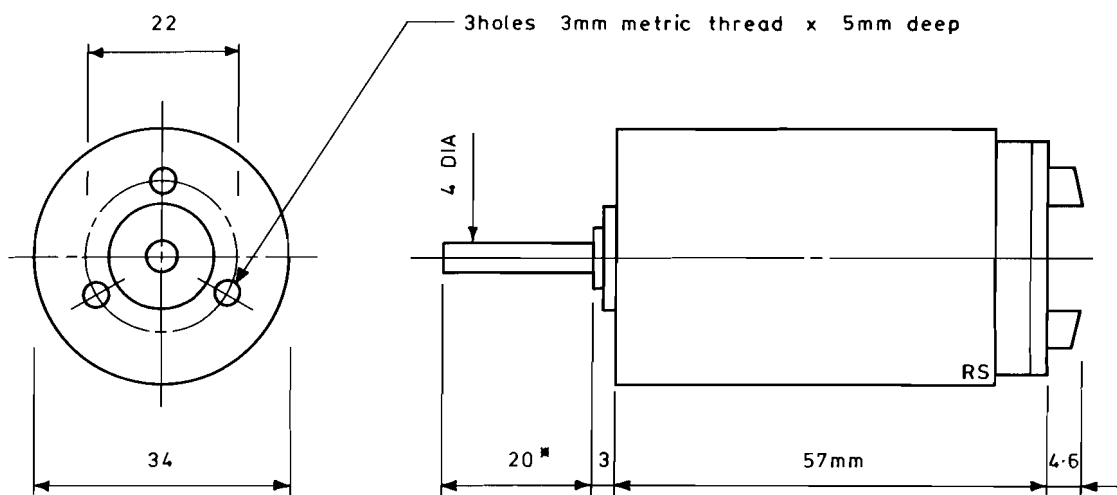

* shaft length 6mm on type 222E motor